

Thank you for your purchasing this product. Before attempting to connect or operate this product, please read these instructions carefully and save this manual for future use.

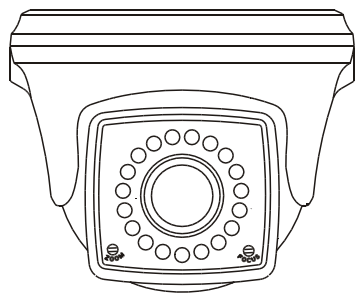

Color High Resolution (IR) Dome Cameras

Operating Instruction

Sony CCD-dnIR



DESCRIPTION

Sony CCD-dnIR adopts a new generation HAWK DSP image processing technology. Resolution is as high as 720+ H-Pixels. It has advanced 3D noise reduction technology, digital WDR, glare suppression and other functions. IR-CUT filter switch over technology will switch the filter to obtain ideal pictures with its mode changing. Powerful OSD menu includes brightness, contrast and color saturation adjustments, multi-area BLC, white balance, AGC and other functions, which ensure clear and bright pictures. Mirror, motion detection, privacy and other aided functions make it suitable for various special environments. Fashion professional design and unique three-dimensional bracket help to carry out a 24-hour monitoring and an easy convenient operation.

Illustrative purposes only!

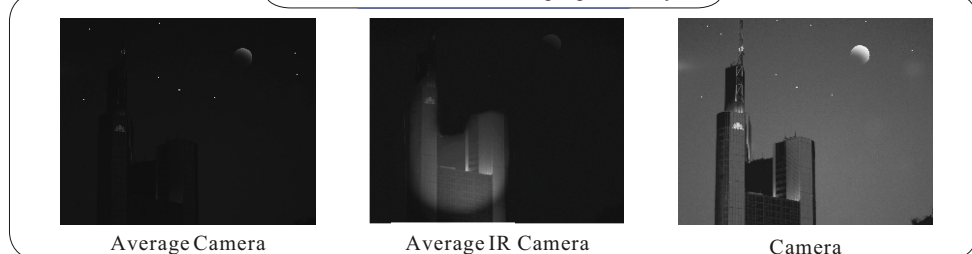

PRECAUTIONS

1. Use correct Power Supply

Wrong connection may cause malfunction and/or damage to the video camera.

2. Do not attempt to disassemble the camera.

To prevent electric shock, do not remove screws or covers. There are no user serviceable parts inside. Ask a qualified service person for servicing.

3. Handle the camera with care.

Do not abuse the camera. Avoid striking, shaking, etc. The camera could be damaged by improper handling or storage.

4. Do not expose the camera to rain or moisture, or try to operate it in wet areas.

Do not place the camera in the following locations:

- ① Locations where temperature is lower than -10°C or higher than 50°C;
- ② Locations where humidity is higher than 95%;
- ③ Locations where there are large amounts of water vapor and steam.

5. Do not use strong or abrasive detergents when cleaning the camera body.

Use a dry cloth to clean the camera when dirty. In case the dirt is hard to remove, use a mild detergent and wipe gently.

6. Clean the Lens faceplate with care.

When cleaning do not use strong or abrasive detergents. Use a piece of lens tissue or cotton tipped applicator and ethanol.

7. Do not attempt to aim the camera at the sun

Do not attempt to aim the camera at the sun or other extremely bright objects that cause smear to appear irrespective of whether the camera is operating or not. This can damage the CCD (Charge Coupled Device).

8. Do not put the camera in a place with interference.

When this camera is installed near equipment like wireless communication device which emits strong electromagnetic field, some irregularity such as noise on monitor screen may happen.

FEATURES

digital WDR

Advanced Digital Wide Dynamic Technology Improves Camera Picture Effect Obtained in the Dark Greatly.

long acting IR light source design

High Performance IR LEDs, Whose Brightness are Higher and Service Life Longer than Ordinary Ones.

high resolution

720 + H-Pixel Resolution

Glare Suppression

Auto Distinguishing Hot Spots, Keeping the High Light Part Off to Improve the Definition of the Whole Picture and Have a Clearer and More Effective Monitoring.

Auto D/N switchover work mode

In the Daytime with Enough Light, Colour Mode is Used; At Night without Enough Light, Auto Turns to B/W Mode and IR Switches on.

IR CUT function

Built-in Filter Switch over Setting, Normal Filter in the Daytime, IR Filter at Night.

IR function

IR will Start when Illumination is below ~ 1 Lux. Range is ~ 15m.

OSD menu function

Powerful Menu Allows for setting all Kinds of Functions for the Camera.

PARTS INSTRUCTION

FUNCTION

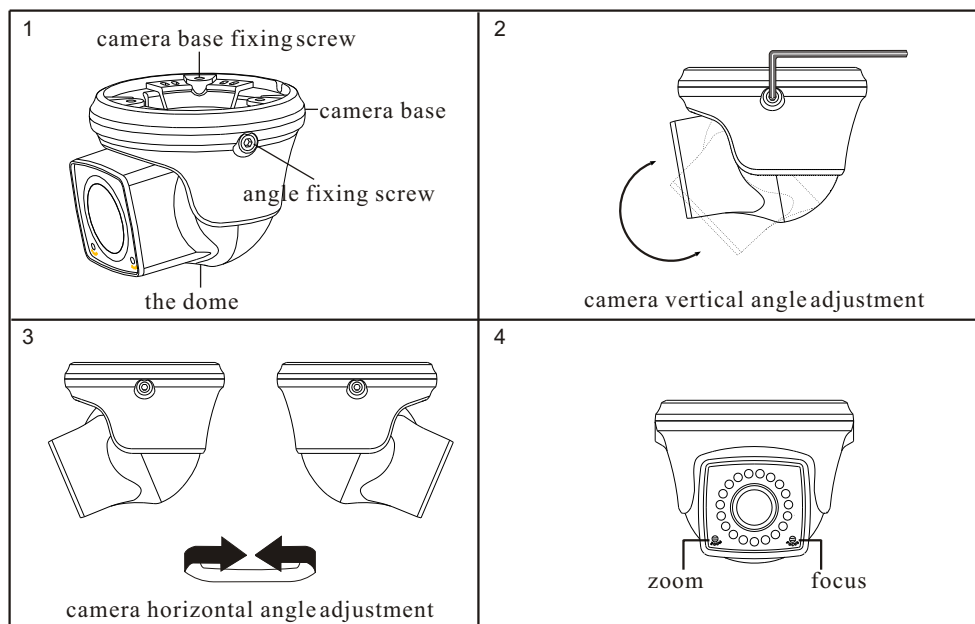

1. Set the camera installing location and fix the camera onto wall with screws.
2. Take the Allen wrench in tool bag and unscrew the angle fixing screw and adjust the camera to required vertical angle and then fix the screw.
3. Take the Allen wrench in tool bag and unscrew the angle fixing screw and adjust the camera to required horizontal angle and then fix the screw.
4. The focal length can be adjusted through zoom and focus bottom

MENU

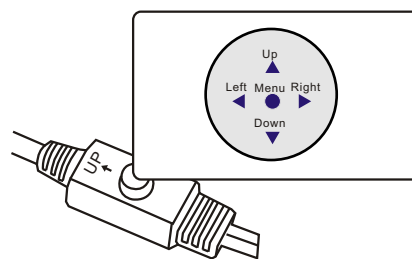

OSD:

ENTER: menu, enter or exit menu.

▲ ▼: up and down button makes cursor move vertically in menu.

◀ ▶: left and right button makes cursor move horizontally in menu or modifies parameter, "L" means there is a submenu, press "enter" to enter the submenu.

dimension (unit: mm)

